

NORKA Luminaire ERFURT single lamp

IP 67     for T8 lamps



Luminaire ERFURT single lamp

Lamps T8  Ø 26 mm

Housing: glass fibre reinforced polyester, lamp holders thermoplastic PBT

Electronics: low loss ballast and starter or electronic ballast, through-wiring 2 x 1,5 mm², 2 access covers 130 mm

Mounting: 2 stainless steel mounting clamps

Gaskets: silicone-/synthetic rubber, non-ageing, form-retaining, short sealing system

Version/Wattage	Order no.	Version/Wattage	Order no.
Luminaire ERFURT with lamp diffuser PMMA opal white – standard version –		Protective tubes see page 81	
1 x 18	ind. 441 210	Reflector tube medium beam	
	comp. 441 220	– PMMA clear	
	HF 441 270	– 18	215 822
1 x 36	ind. 441 410	– 36	215 824
	comp. 441 420	– 58	215 826
	HF 441 470	– PMMA clear, inside ribbed	
1 x 58	ind. 441 610	– 18	215 832
	comp. 441 620	– 36	215 834
	HF 441 670	– 58	215 836
Luminaire ERFURT without lamp diffuser		– PMMA clear, with cross louvre	
1 x 18	ind. 441 21V	– 18	215 922
	comp. 441 22V	– 36	215 924
	HF 441 27V	– 58	215 926
1 x 36	ind. 441 41V	– PMMA transopal, impact resistant	
	comp. 441 42V	– 18	217 832
	HF 441 47V	– 36	217 834
1 x 58	ind. 441 61V	– 58	217 836
	comp. 441 62V	– PMMA clear, impact resistant	
	HF 441 67V	– 18	217 822
		– 36	217 824
		– 58	217 826
Accessories and additional prices			
Lamp diffuser			
– PMMA opal white			
– 18	205 502	– PC clear (fracture proof)	
– 36	205 504	– 18	515 822
– 58	205 506	– 36	515 824
– PMMA clear, inside ribbed			
– 18	205 512	– 58	515 826
– 36	205 514	– PC clear (fracture proof), inside ribbed	
– 58	205 516	– 18	515 832
– PC opal white (fracture proof)			
– 18	505 502	– 36	515 834
– 36	505 504	– 58	515 836
– 58	505 506	– PC clear (fracture proof), with cross louvre	
– PC clear (fracture proof), inside ribbed			
– 18	505 512	– 18	515 922
– 36	505 514	– 36	515 924
– 58	505 516	– 58	515 926
– PMMA clear, inside ribbed, with additional tube, clear			
– 18	205 612	High efficiency reflector tube 08 medium beam	
– 36	205 614	– PMMA clear	
– 58	205 616	– 18	218 822
– PC clear (fracture proof), inside ribbed, with additional tube, clear			
– 18	505 612	– 36	218 824
– 36	505 614	– 58	218 826
– 58	505 616	– PC clear (fracture proof)	
		– 18	518 822
		– 36	518 824
		– 58	518 826
		– PMMA transopal, impact resistant	
		– 18	217 092
		– 36	217 094
		– 58	217 096

Luminaire ERFURT single lamp

IP 67     for T8 lamps



	L	Dimensions in mm		a	Weight approx. kg
		B	H		
18 W	641	61	120	420 ± 30	2,1
36 W	1251	61	120	980 ± 80	2,8
58 W	1551	61	120	1280 ± 80	3,7

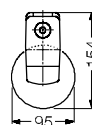
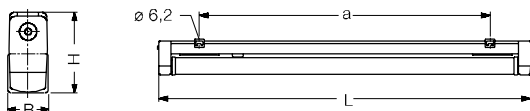

Lamp diffuser Ø 90 mm

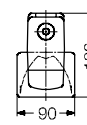

Square diffuser wide beam

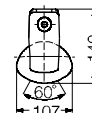

Reflector tube medium beam

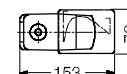

Square diffuser asymmetric beam

Version/Wattage	Order no.	Version/Wattage	Order no.
Reflector tube narrow beam		Through-wiring 4 x 1,5 mm²	
- PMMA clear		- 18	441 802
- 18	215 992	- 36	441 804
- 36	215 994	- 58	441 806
- 58	215 996		
- PMMA clear, with cross louvre		Continuous row connector	
- 18	215 092	- 4 x 1,5 mm ²	201 423
- 36	215 094		
- 58	215 096	NORKA safety starter	
		electronic	200 91
Reflector tube medium beam		Safety-/rapid starter	
with round louvre, metallised with bi-reflectors		(DEOS)	200 11
- PMMA clear		Plastic cable gland with strain relief	
- 18	211 483	M 20	200 427
- 36	211 485	M 20 (pair)	201 427
- 58	211 487	Wire suspension for 1 m suspension	
- PC clear (fracture proof)		(pair)	200 278
- 18	511 483	Plastic mounting clamps	
- 36	511 485	for aggressive atmospheres	200 226
- 58	511 487	Knurled screws	441 001
Square diffuser with mirrorfinish reflector		Colour finish according to RAL	441 960
- PMMA clear, wide beam			
- 18 W	214 613	Spare parts	
- 36	214 615	Face piece with contact insert	
- 58	214 617	- 18 - 58	181 43
- PMMA clear, asymmetric beam		Pressure cap	
- 18	215 562	- 18 - 58	183 62
- 36	215 564	Starter cap	
- 58	215 566	- 18 - 58	141 70
- PMMA clear, wide beam with cross louvre		Holding frame	
- 18	214 623	- 18 - 58	201 95
- 36	214 625	Mounting clamps	200 222
- 58	214 627		
- PC clear (fracture proof), wide beam		Contact insert	200 316
- 18	514 613	Silicone sealing ring	200 352
- 36	514 615		
- 58	514 617	Guiding piece	
- PC clear (fracture proof), wide beam with cross louvre		without contact insert	189 27
- 18	514 623		
- 36	514 625	Ballast	
- 58	514 627	- 18	212 00
Reflector tube Ø 90 mm with mirrorfinish reflector		- 36	214 00
- PMMA clear, wide beam		- 58	216 50
- 18	211 522		
- 36	211 524		
- 58	211 526		
- PMMA clear, wide beam with perforated reflector for up-lighting			
- 18	211 542		
- 36	211 544		
- 58	211 546		

NORKA Luminaire ERFURT single lamp

IP 65     for lamps T5



Luminaire ERFURT single lamp

Lamps T5  Ø 16 mm

Housing: glass fibre reinforced polyester, lamp holders thermoplastic PBT
Electronics: electric ballast, through-wiring 2 x 1,5 mm², 2 access covers 130 mm
Mounting: 2 stainless steel mounting clamps
Gaskets: silicone-/synthetic rubber, non-ageing, form-retaining, short sealing system

Version/Wattage	Order no.	Version/Wattage	Order no.
Luminaire ERFURT with reflector tube medium beam		- PC clear (fracture proof)	
PMMA clear – standard version –		- 24	515 823
1 x 24 T5 HF	441 170	- 39	515 821
1 x 28 T5 HF	441 070	- 28/54	515 827
1 x 39 T5 HF	441 570	- 49/80	515 828
1 x 49 T5 HF	441 970	- PC clear (fracture proof), inside ribbed	
1 x 54 T5 HF	441 770	- 24	515 833
1 x 80 T5 HF	441 870	- 39	515 831
Luminaire ERFURT without reflector tube		- 28/54	515 837
1 x 24 T5 HF	441 17V	- 49/80	515 838
1 x 28 T5 HF	441 07V	- PC clear (fracture proof), with cross louvre	
1 x 39 T5 HF	441 57V	- 24	515 923
1 x 49 T5 HF	441 97V	- 39	515 921
1 x 54 T5 HF	441 77V	- 28/54	515 927
1 x 80 T5 HF	441 87V	- 49/80	515 928
Accessories and additional prices		- PC clear (fracture proof), with round louvre, metallised and bi-reflectors	
Reflector tube 09 medium beam		- 24	511 489
- PMMA clear		- 39	511 481
- 24	215 823	- 28/54	511 490
- 39	215 821	- 49/80	511 488
- 28/54	215 827	- PC clear (fracture proof), inside ribbed, with cross louvre	
- 49/80	215 828	- 24	515 933
- PMMA clear, inside ribbed		- 39	515 931
- 24	215 833	- 28/54	515 937
- 39	215 831	- 49/80	515 938
- 28/54	215 837	Reflector tube 09 narrow beam	
- 49/80	215 838	- PMMA clear	
- PMMA clear, with cross louvre		- 24	215 999
- 24	215 923	- 39	215 990
- 39	215 921	- 28/54	215 991
- 28/54	215 927	- 49/80	215 998
- 49/80	215 928	- PMMA clear, with cross louvre	
- PMMA clear, inside ribbed with cross louvre		- 24	215 099
- 24	215 933	- 39	215 090
- 39	215 931	- 28/54	215 091
- 28/54	215 937	- 49/80	215 098
- 49/80	215 938	- PC clear (fracture proof)	
- PMMA clear, with round louvre, metallised and bi-reflectors		- 24	515 999
- 24	211 489	- 39	515 990
- 39	211 481	- 28/54	515 991
- 28/54	211 490	- 49/80	515 998
- 49/80	211 488	- PC clear (fracture proof), with cross louvre	
- PMMA transopal, impact resistant		- 24	515 099
- 24	217 843	- 39	515 090
- 39	217 841	- 28/54	515 091
- 28/54	217 847	- 49/80	515 098
- 49/80	217 848		
- PMMA clear, impact resistant			
- 24	217 823		
- 39	217 821		
- 28/54	217 827		
- 49/80	217 828		

Luminaire ERFURT single lamp

IP 65     for lamps T5



for T5 lamps reflector tube 09 medium beam

	L	Dimensions in mm			Weight approx. kg
		B	H	a	
24 W	600	107	140	350 ± 50	1,7
28 W	1200	107	140	930 ± 80	2,5
39 W	900	107	140	650 ± 50	2,1
54 W	1200	107	140	930 ± 80	2,5
49 W	1500	107	140	1230 ± 80	2,9
80 W	1500	107	140	1230 ± 80	2,9

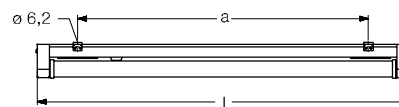
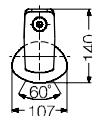

Version/Wattage Order no.

Lamp cover

– PMMA clear, inside ribbed

– 24	205 513
– 39	205 511
– 28/54	205 517
– 49/80	205 518

– PC clear (fracture proof), inside ribbed

– 24	505 513
– 39	505 511
– 28/54	505 517
– 49/80	505 518

Reflector tube Ø 90 mm with mirrorfinish reflector

– PMMA clear, wide beam

– 24	211 529
– 39	211 520
– 28/54	211 521
– 49/80	211 528

– PMMA clear, wide beam with perforated reflector for up-lighting

– 24	211 549
– 39	211 540
– 28/54	211 541
– 49/80	211 548

Through-wiring 4 x 1,5 mm²

– 24	441 801
– 39	441 803
– 28/54	441 804
– 49/80	441 806

Plastic cable gland with strain relief

M 20	200 427
M 20 (pair)	201 427

Wire suspension for 1 m suspension

(pair)	200 278
--------	---------

Plastic mounting clamps

for aggressive atmosphere	200 226
---------------------------	---------

Knurled screws	441 001
----------------	---------

Colour finish according to RAL	441 960
--------------------------------	---------

Version/Wattage Order no.

Spare parts

Face piece

with contact insert	351 54
---------------------	--------

Pressure cap

	351 57
--	--------

Holding frame

	201 95
--	--------

Mounting clamps

	200 222
--	---------

Contact insert

	200 310
--	---------

Silicone sealing ring

	200 352
--	---------

Guiding piece

without contact insert	334 40
------------------------	--------

Adjustable tilt angle for reflector tube

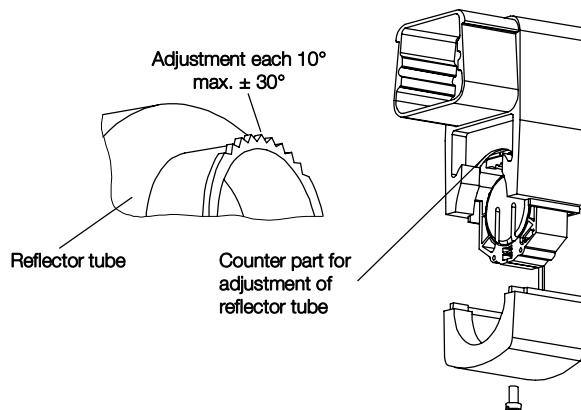

NORKA Luminaire ERFURT twin lamp

IP 65    for T8 lamps



Luminaire ERFURT twin lamp

Lamps T8  Ø 26 mm

Housing: glass fibre reinforced polyester, lamp holders thermoplastic PBT

Electronics: low loss ballast and starter or electronic ballast, through-wiring 2 x 1,5 mm², 2 access covers 130 mm

Mounting: 2 stainless steel mounting clamps

Gaskets: silicone-/synthetic rubber, non-ageing, form-retaining, short sealing system

Version/Wattage	Order no.	Version/Wattage	Order no.
Luminaire ERFURT with 2 reflector tubes medium beam			
PMMA clear – standard version –			
2 x 36 T8 ind.	442 410	2 Reflector tubes 08 medium beam	
T8 comp.	442 420	– PMMA clear	
T8 HF	442 470	– 2 x 36	218 824
2 x 58 T8 ind.	442 610	– 2 x 58	218 826
T8 comp.	442 620	– PC clear (fracture proof)	
T8 HF	442 670	– 2 x 36	518 824
Luminaire ERFURT without reflector tubes			
2 x 36 T8 ind.	442 41V	– 2 x 58	518 826
T8 comp.	442 42V	2 Reflector tubes narrow beam	
T8 HF	442 47V	– PMMA clear	
2 x 58 T8 ind.	442 61V	– 2 x 36	215 994
T8 comp.	442 62V	– 2 x 58	215 996
T8 HF	442 67V	– PMMA clear, with cross louvre	
Accessories and additional prices			
2 Reflector tubes medium beam		– 2 x 36	215 094
– PMMA clear		– 2 x 58	215 096
– 2 x 36	215 824	2 Reflector tubes medium beam	
– 2 x 58	215 826	with round louvre, metallised and bi-reflectors	
– PMMA clear, inside ribbed		– PMMA clear	
– 2 x 36	215 834	– 2 x 36	211 485
– 2 x 58	215 836	– 2 x 58	211 487
– PMMA clear, with cross louvre		– PC clear (fracture proof)	
– 2 x 36	215 924	– 2 x 36	511 485
– 2 x 58	215 926	– 2 x 58	511 487
– PC clear (fracture proof)		2 Square lamp diffusers with mirrorfinish reflector	
– 2 x 36	515 824	– PMMA clear, wide beam	
– 2 x 58	515 826	– 2 x 36	214 615
– PC clear (fracture proof), inside ribbed		– 2 x 58	214 617
– 2 x 36	515 834	– PMMA clear, asymmetric beam	
– 2 x 58	515 836	– 2 x 36	215 564
– PC clear (fracture proof), with cross louvre		– 2 x 58	215 566
– 2 x 36	515 924	– PMMA clear, wide beam with cross louvre	
– 2 x 58	515 926	– 2 x 36	214 625
2 Reflector tubes medium beam		– 2 x 58	214 627
– PMMA transopal, impact resistant		– PC clear (fracture proof), wide beam	
– 2 x 36	217 834	– 2 x 36	514 615
– 2 x 58	217 836	– 2 x 58	514 617
– PMMA clear, impact resistant		– PC clear (fracture proof), wide beam with cross louvre	
– 2 x 36	217 824	– 2 x 36	514 625
– 2 x 58	217 826	– 2 x 58	514 627

Luminaire ERFURT twin lamp

IP 65      for T8 lamps



	L	Dimension in mm		a	Weight approx. kg
		B	H		
36 W	1251	242	140	920 ± 80	4,3
58 W	1551	242	140	1220 ± 80	5,6

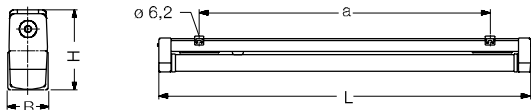

Version/Wattage	Order no.
2 Reflector tubes Ø 90 mm with mirrorfinish reflector	
– PMMA clear, wide beam	
– 2 x 36	211 524
– 2 x 58	211 526
– PMMA clear, wide beam with perforated reflector for up-lighting	
– 2 x 36	211 544
– 2 x 58	211 546
Through-wiring 4 x 1,5 mm²	
– 36	442 804
– 58	442 806
NORKA safety starter	
electronic	2 x 200 91
Safety-/rapid starter	2 x 200 11
Plastic cable gland with strain relief	
M 20	200 427
M 20 (pair)	201 427
Wire suspension for 1 m suspension (pair)	
	200 278
Plastic mounting clamps for aggressive atmosphere	
	200 226
Knurled screws	442 001
Colour finish according to RAL	442 960

Version/Wattage	Order no.
Spare parts	
Ballast	
– 36	214 00
– 58	216 50
Face piece with contact insert	265 02
Pressure cap	183 62
Starter cap	141 70
Holding frame	201 95
Mounting clamp	200 222
Contact insert	200 316
Silicone sealing ring	200 352
Guiding piece without contact insert	189 27



NORKA Luminaire ERFURT twin lamp

IP 65     for lamps T5



Luminaire ERFURT twin lamp

Lamps T5  Ø 16 mm

Housing: glass fibre reinforced polyester, lamp holders thermoplastic PBT

Electronics: low loss ballast and starter or electronic ballast, through-wiring 2 x 1,5 mm², 2 access covers 130 mm

Mounting: 2 stainless steel mounting clamps

Gaskets: silicone-/synthetic rubber, non-ageing, form-retaining, short sealing system

Version/Wattage	Order no.	Version/Wattage	Order no.
Luminaire ERFURT with 2 reflector tubes 09 medium beam			
PMMA clear – standard version –			
2 x 28 T5 HF	442 070	- PC clear (fracture proof)	
2 x 39 T5 HF	442 570	- 2 x 39	515 821
2 x 49 T5 HF	442 970	- 2 x 28/54	515 827
2 x 54 T5 HF	442 770	- 2 x 49/80	515 828
2 x 80 T5 HF	442 870	- PC clear (fracture proof), inside ribbed	
Luminaire ERFURT without reflector tubes			
2 x 28 T5 HF	442 07V	- 2 x 39	515 831
2 x 39 T5 HF	442 57V	- 2 x 28/54	515 837
2 x 49 T5 HF	442 97V	- 2 x 49/80	515 838
2 x 54 T5 HF	442 77V	- PC clear (fracture proof), with cross louvre	
2 x 80 T5 HF	442 87V	- 2 x 39	515 921
Accessories and additional prices			
2 Reflector tubes 09 medium beam			
- PMMA clear			
- 2 x 39	215 821	- 2 x 28/54	515 927
- 2 x 28/54	215 827	- 2 x 49/80	515 928
- 2 x 49/80	215 828	- PC clear (fracture proof), inside ribbed, with cross louvre	
- PMMA clear, inside ribbed			
- 2 x 39	215 831	- 2 x 39	515 931
- 2 x 28/54	215 837	- 2 x 28/54	515 937
- 2 x 49/80	215 838	- 2 x 49/80	515 938
- PMMA clear, with cross louvre			
- 2 x 39	215 921	2 Reflector tubes 09 narrow beam	
- 2 x 28/54	215 927	- PMMA clear	
- 2 x 49/80	215 928	- 2 x 39	215 990
- PMMA clear, with round louvre, metallised and 2 bi-reflectors			
- 2 x 39	211 481	- 2 x 28/54	215 991
- 2 x 28/54	211 490	- 2 x 49/80	215 998
- 2 x 49/80	211 488	- PMMA clear, with cross louvre	
- PMMA clear, inside ribbed, with cross louvre			
- 2 x 39	215 931	- 2 x 39	215 090
- 2 x 28/54	215 937	- 2 x 28/54	215 091
- 2 x 49/80	215 938	- 2 x 49/80	215 098
- PMMA transopal, impact resistant			
- 2 x 39	217 841	- PC clear (fracture proof)	
- 2 x 28/54	217 847	- 2 x 39	515 990
- 2 x 49/80	217 848	- 2 x 28/54	515 991
- PMMA clear, impact resistant			
- 2 x 39	217 821	- 2 x 49/80	515 998
- 2 x 28/54	217 827	- PC clear (fracture proof), with cross louvre	
- 2 x 49/80	217 828	- 2 x 39	515 090
		- 2 x 28/54	515 091
		- 2 x 49/80	515 098
		- PC clear (fracture proof), with round louvre, metallised and 2 bi-reflectors	
		- 2 x 39	511 481
		- 2 x 28/54	511 490
		- 2 x 49/80	511 488



Luminaire ERFURT twin lamp

IP 65      for lamps T5



for T5 lamps reflector tube 09 medium beam

	L	Dimension in mm			a	Weight approx. kg
		B	H			
28 W	1200	242	140	930 ± 80	2,5	
39 W	900	242	140	650 ± 50	2,1	
54 W	1200	242	140	930 ± 80	2,5	
49 W	1500	242	140	1230 ± 80	2,9	
80 W	1500	242	140	1230 ± 80	2,9	

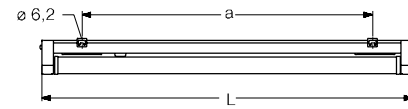
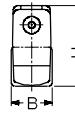

Version/Wattage	Order no.
2 Reflector tubes Ø 90 mm, with mirrorfinish reflector	
– PMMA clear, wide beam	
– 2 x 39	211 520
– 2 x 28/54	211 521
– 2 x 49/80	211 528
– PMMA clear, wide beam with perforated reflector	
for up-lighting	
– 2 x 39	211 540
– 2 x 28/54	211 541
– 2 x 49/80	211 548
Through-wiring 4 x 1,5 mm²	
– 39	442 803
– 28/54	442 804
– 49/80	442 806
Plastic cable gland with strain relief	
M 20	200 427
M 20 (pair)	201 427
Wire suspension for 1 m suspension	
(pair)	200 278
Plastic mounting clamps	
for aggressive atmosphere	200 226
Knurled screws	442 001
Colour finish according to RAL	442 960

Version/Wattage	Order no.
Spare parts	
Face piece	
with contact insert	440 29
Pressure cap	351 57
Holding frame	201 95
Mounting clamp	200 222
Contact insert	200 310
Silicone sealing ring	200 352
Guiding piece	
without contact insert	334 40

High performance by use of NORKA reflector technology and T5 lamps

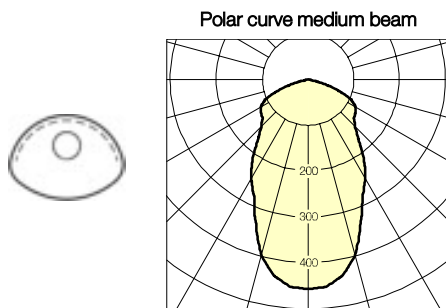

Efficiency factor:
 $\eta_{LB} = 91 \% \text{ l (cd/km)}$

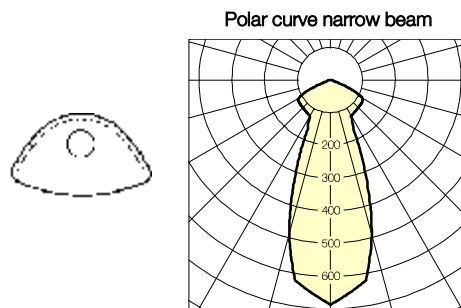

Efficiency factor:
 $\eta_{LB} = 93 \% \text{ l (cd/km)}$