





 850 °C, vandalism proof  40 Joule
-certified



Impact-resistant vandalism proof surface mounted luminaire in stainless steel, with rectangular opal (or structured) clear PC lamp diffuser, 4 mm, with stainless steel end caps. Two M20 cable entries at the ends, with optional rear cable entries. Two allen screws. Fixation through four concealed fastening bores at the rear. Integrated single-lamp polymer luminaire, IP 65, protection class II, with built-in low loss ballast and starter or ECG. Ready for connection, through wiring 2 x 1.5 mm². Two access covers. Available in RAL colours.



Vandalism proof luminaire

medium beam, opal			wide beam, clear			asymmetric beam, clear		
1 x 18 W	comp.	744 22	1 x 18 W	comp.	746 22	1 x 18 W	comp.	746 32
	ECG	744 27		ECG	746 27		ECG	746 37
1 x 36 W	comp.	744 42	1 x 36 W	comp.	746 42	1 x 36 W	comp.	746 52
	ECG	744 47		ECG	746 47		ECG	746 57
1 x 58 W	comp.	744 62	1 x 58 W	comp.	746 62	1 x 58 W	comp.	746 72
	ECG	744 67		ECG	746 67		ECG	746 77

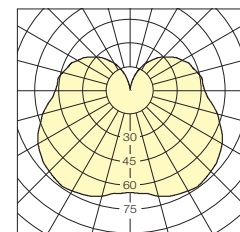
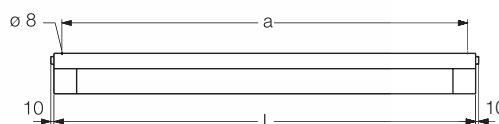
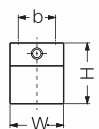

Version	L	Dimensions in mm (± 2 mm)			b	Weight kg (approx.)
		W	H	a		
18/24 W	740	115	130	690	80	5.5
28/36/54 W	1340	115	130	1290	80	8.2
35/49/58 W	1640	115	130	1590	80	10.5

1 x T8 / 58 W
PC opal white



special screws,
three-hole or semi-circle



optional: clear,
with integrated reflector

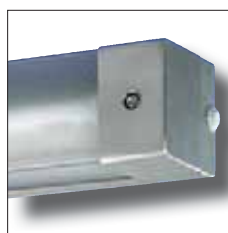

with structured
lamp diffuser



anti-graffiti coating
available on request



optional:
rearward cable entry



medium beam, opal			wide beam, clear			asymmetric beam, clear		
1 x 24 W	ECG	744 17	1 x 24 W	ECG	746 17	1 x 24 W	ECG	747 17
1 x 28 W	ECG	744 07	1 x 28 W	ECG	746 07	1 x 28 W	ECG	747 07
1 x 35 W	ECG	744 37	1 x 35 W	ECG	746 371	1 x 35 W	ECG	747 37
1 x 49 W	ECG	744 97	1 x 49 W	ECG	746 97	1 x 49 W	ECG	747 97
1 x 54 W	ECG	744 77	1 x 54 W	ECG	746 771	1 x 54 W	ECG	747 77
1 x 80 W	ECG	744 87	1 x 80 W	ECG	746 87	1 x 80 W	ECG	747 87