







IP 65      protection class I  ball impact resistant
DB-certified available on request

Housing in cast aluminium, satin finish.
 Frameless hinged safety glass cover screen.
 Internal mirror finish reflector, wide, concentrated wide, concentrated or asymmetric beam. Integrated ballast with thermal circuit breaker and starter (if required) with automatic cut-out.
 Ready for connection through two M20 cable glands.
 For installation with two M10 mounting bolts in ceiling.
 Also available in RAL colours.



POLLUX



POLLUX with PC hood cover for food processing industry, conforming to HACCP and IFS, for max. 250 W.
 Ref. no. 982 016



wide beam, inductive – standard version –			wide beam, inductive – standard version –			concentrated wide beam, inductive		
E40 socket			E40 socket			E40 socket		
HME	250 W	985 111	HIT	400 W	985 116	HIT	250 W	985 309
HME	400 W	985 120	HIT ¹⁾	400 W HS ballast	985 117	HIT	400 W	985 316
HIE	250 W	985 108	HST	250 W	985 113	HIT ¹⁾	400 W HS ballast	985 317
HIE ²⁾	400 W	985 115	HST	400 W	985 123	HST	250 W	985 313
HIE ²⁾	400 W HS ballast	985 125				HST	400 W	985 323
HSE	250 W	985 112						
HSE	400 W	985 122						
HIT	250 W	985 109						

POLLUX – standard version -

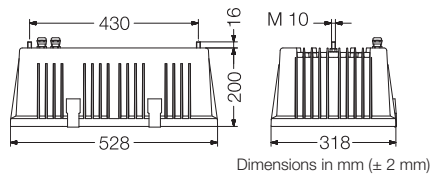

POLLUX with swivel bracket, cross

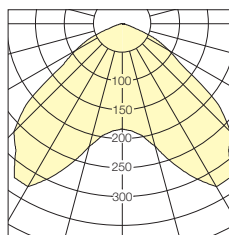
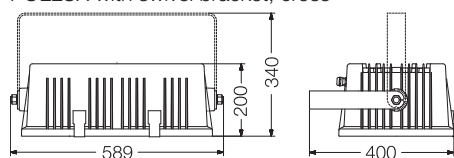

I (cd/klm) LOR = 66 %
1 x HIT/400 W wide beam

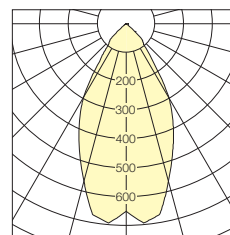

I (cd/klm) LOR = 64 %
1 x HIT-DE/400 W concentrated wide beam, HS ballast

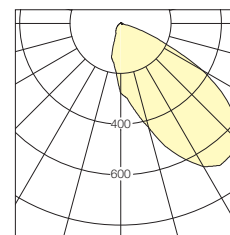

I (cd/klm) LOR = 63 %
1 x HST-DE/250 W asymmetric beam

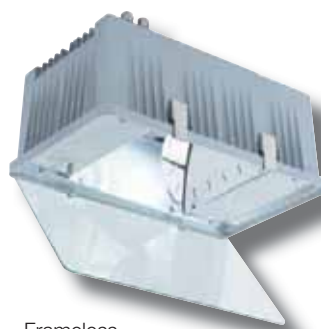

Frameless cover screen



POLLUX with multi-purpose and emergency lamp



POLLUX with cross swivel bracket
Ref. no. 982 107

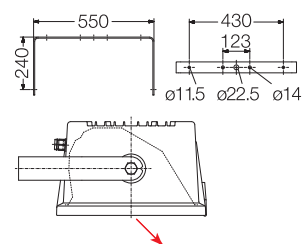

POLLUX with axial swivel bracket
Ref. no. 982 127

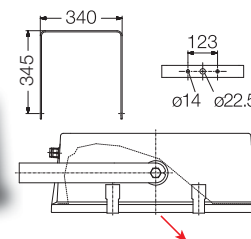

concentrated wide beam, inductive

Fc2 socket

HIT-DE 250 W	985 310
HIT-DE 400 W	985 318
HIT-DE ¹⁾ 400 W HS ballast	985 319
HST-DE 250 W	985 314
HST-DE 400 W	985 324

with ENDURA lamp and ECG (included in delivery)

100 W	985 366
-------	---------

concentrated wide beam, inductive with secondary reflector system

E40 socket

HIT 250 W	985 909
HST 250 W	985 913

Fc2 socket

HIT-DE 250 W	985 910
--------------	---------

¹⁾ Optimised for operation with HS ballast and OSRAM lamps
²⁾ For OSRAM HQI-E 400 W-D lamps only
Observe lamp manufacturer instructions re. operating position

IP 65     protection class I

 * ball impact resistant -certified

* available on request

POLLUX

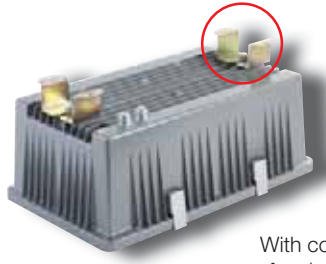

With cover plate for short ceiling mounting distance



 Ball impact resistant version



With swivel bracket and anti vibration dampers

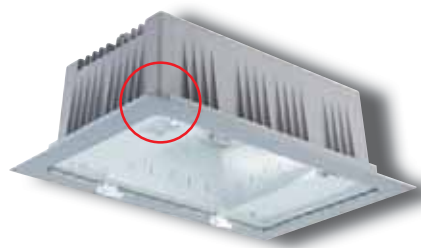

Frame for recessed ceiling installation



concentrated beam, inductive			concentrated beam, inductive			extreme narrow beam, inductive		
E40 socket			Fc2 socket			E40 socket		
HIT	250 W	985 209	HIT-DE	250 W	985 210	HIT	250 W	985 609
HIT	400 W	985 216	HIT-DE	400 W	985 218	HIT	400 W	985 616
HIT ¹⁾	400 W HS ballast	985 217	HIT-DE ¹⁾	400 W HS ballast	985 219	HIT ¹⁾	400 W HS ballast	985 617
HST	250 W	985 213				HST	150 W	985 605
HST	400 W	985 223				HST	250 W	985 613
						HST	400 W	985 623
						HST	600 W	985 669



Wiring diagram:

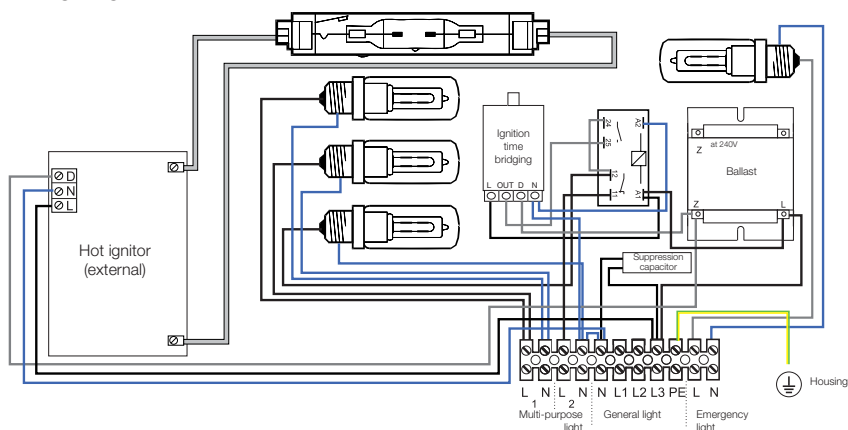

New exhibition centre Karlsruhe

Implemented lighting system:

1. General lighting 300 lx
2. Corridor illumination along escape routes
3. Multi-purpose lighting
4. Emergency lighting, covering large areas due to changing room utilisation
5. Anti-panic lighting together with general illumination



NORKA hot ignitor for POLLUX-WZ
fully electronic/fully automatic,
with safety pilot.
For immediate re-ignition of the hot lamp
after power failures up to 400 W.

asymmetric beam, inductive,
longitudinal

Fc2 socket

HIT-DE	250 W	985 810
HIT-DE	400 W	985 818
HIT-DE ¹⁾	400 W HS ballast	985 819
HST-DE	250 W	985 814
HST-DE	400 W	985 824

asymmetric beam, inductive,
cross

E40 socket

HIT	250 W	985 709
HIT	400 W	985 716
HIT ¹⁾	400 W HS ballast	985 717
HST	250 W	985 713
HST	400 W	985 723

¹⁾ Optimised for operation with HS ballast and OSRAM lamps
²⁾ For OSRAM HQI-E 400 W-D lamps only
Observe lamp manufacturer instructions re. operating position